

HM2D4

- Nickel plated alloy steel IP68 spoke type load cell
- Tension and compression applications
- Suitable for truck scales, hopper scales, automobile testing facilities and other electronic weighing or force measuring field.



| Available models | | |
|------------------|----------|--------------------------|
| Capacity | Accuracy | Full article description |
| 0.5t~10t | C3 | HM2D4-C3-xxt-5B6 |
| 20t | G1 | HM2D4-G1-20t-5B6 |
| 50t | G3 | HM2D4-G3-50t-5B6 |

Specification

| Accuracy class | | C3 | G1 | G3 |
|---|--------------|----------------|--------|-------|
| Maximum capacity (E_{max}) | t | 0.5/1/2/3/5/10 | 20 | 50 |
| Ratio of minimum LC verification interval $Y = E_{max} / v_{min}$ | v_{min} | 7500 | | |
| Combined error | %FS | 0.02 | 0.1 | 0.3 |
| Creep | %FS/30min | ± 0.016 | ± 0.05 | ± 0.1 |
| Temperature effect on sensitivity | %FS/10°C | ± 0.011 | ± 0.1 | ± 0.2 |
| Temperature effect on zero | %FS/10°C | ± 0.019 | ± 0.1 | ± 0.2 |
| Output sensitivity (= FS) | mV/V | 2.0 ± 0.002 | | |
| Input resistance | Ω | 350 ± 3.5 | | |
| Output resistance | Ω | 350 ± 3.5 | | |
| Insulation resistance | MΩ | ≥ 5000(50VDC) | | |
| Zero balance | %FS | 0~1.0 | | |
| Compensated temperature | °C | -10~+40 | | |
| Operating temperature | °C | -35~+65 | | |
| Excitation, recommended voltage | V | 5~12(DC) | | |
| Excitation maximum | V | 18(DC) | | |
| Safe overload | of E_{max} | 150 | | |
| Ultimate overload | of E_{max} | 300 | | |

Dimensions in mm

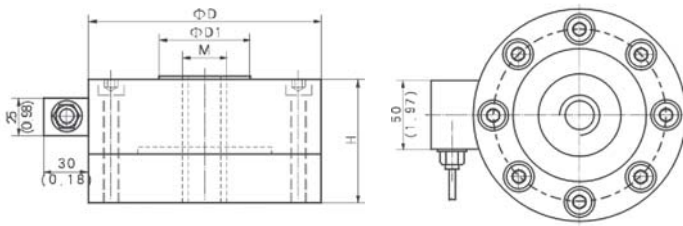

| Dimension | D | D1 | H | M |
|-----------|---------------|----------------|---------------|-----------|
| Capacity | | | | |
| 0.5t~2t | 105 (4.13) | 28 (1.10) | 70 (2.76) | M14 × 2 |
| 3t, 5t | 120 (4.72) | 33 (1.3) | 80 (3.15) | M20 × 1.5 |
| 10t, 20t | 155 (6.10) | 60.5 (2.38) | 90 (3.54) | M32 × 2 |
| 50t | 200 (7.87) | 75 (2.95) | 120 (4.72) | M45 × 3 |

Wiring

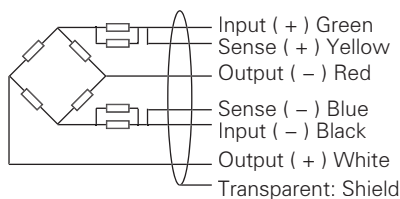

- Shielded, 6 conductor cable: Φ5.6mm
- Standard cable length: 5m